

7352B.MP

Schrägkugellager (einreihig, metrisch)

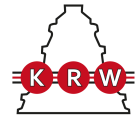

Details:

Hauptabmessungen

d [mm]	260	D_1 [mm]	$\approx 438,5$
D [mm]	540	$r_{1,2}$ [mm]	6
B [mm]	102	$r_{3,4}$ [mm]	3
Gewicht [kg]	≈ 116	α_0 [°]	40
d_1 [mm]	$\approx 369,6$	a [mm]	≈ 219

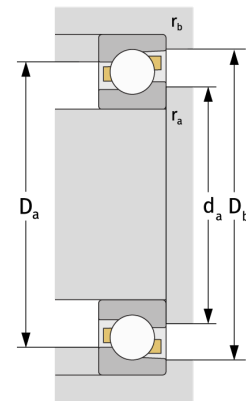
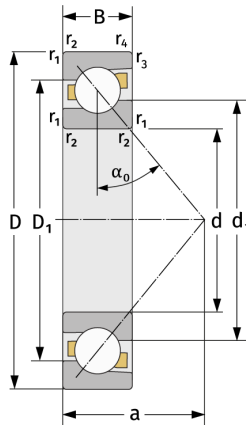

Anschlussmaße		Berechnungsdaten	
$d_{a, \min}$ [mm]	286	C [kN]	670
$D_{a, \max}$ [mm]	514	C_0 [kN]	1070
$D_{b, \max}$ [mm]	526	C_u [kN]	26,6
$r_{a, \max}$ [mm]	5	n_{th} [min ⁻¹]	1148
$r_{b, \max}$ [mm]	2,5	n_g [min ⁻¹]	1600